

BREW Mobile App

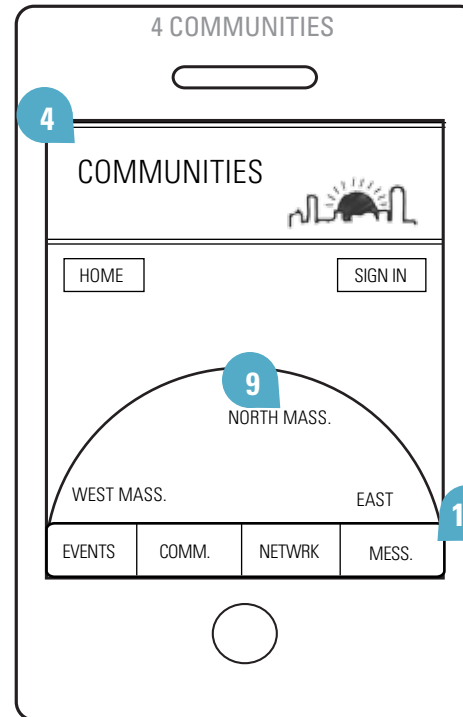

- 1 First page is a log in page. The user will be able to choose their preferred method of signing into BREW. Also shown is the menu options, and a sign up option for new users.
- 2 Second page is the main menu page that will be displayed after the user is logged into BREW.
- 3 This is the Events page for BREW. The user has the option to return back to the home menu page, or sign in to BREW.
- 4 This is the Communities page for BREW. This page will display a map of MA broken down into geographical communities.
- 5 The user has the option to sign in using other methods such as twitter or facebook.
- 6 This is a button that will take the user to a page that will allow them to search for an event according to topic, event type or location (8).
- 7 This button allows the user to add an event to a list of favorites.
- 8 On the events page a calender of events is displayed for the user. When the user clicks on an event an event description will load (7).
- 9 The user has the option of clicking on a community and learning more about that community's members and events.
- 10 There will be a panel of menu buttons at the bottom of every page to allow the user to access the other options easily.

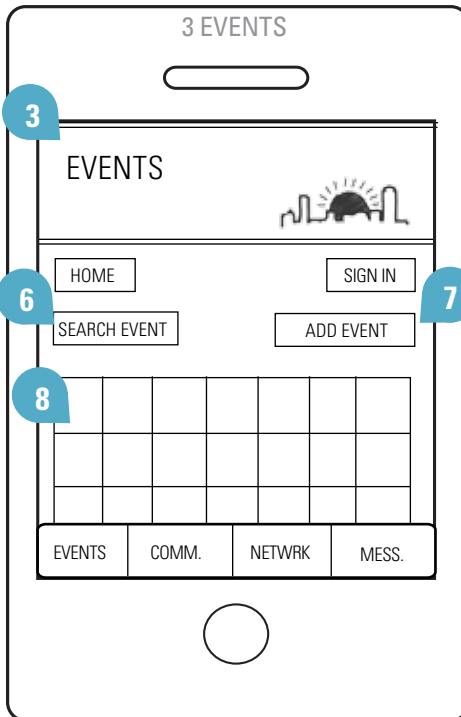
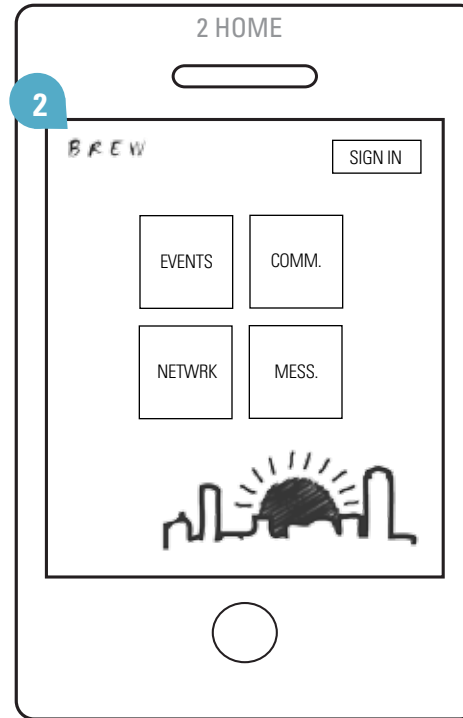
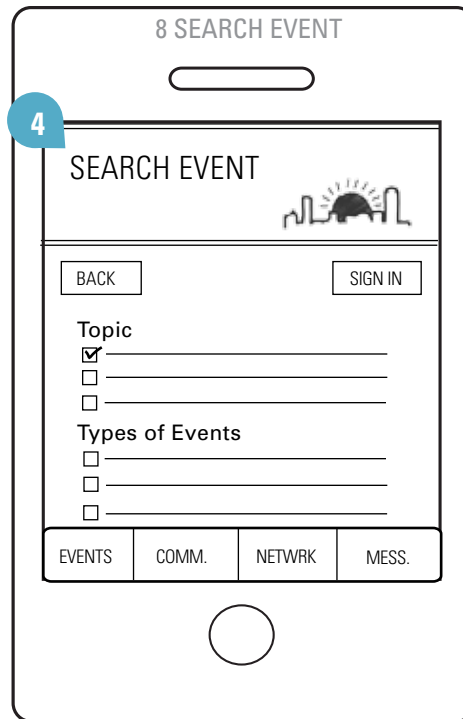
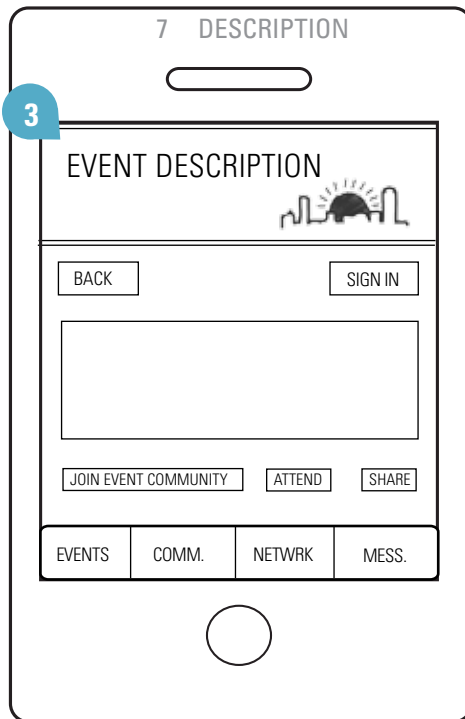
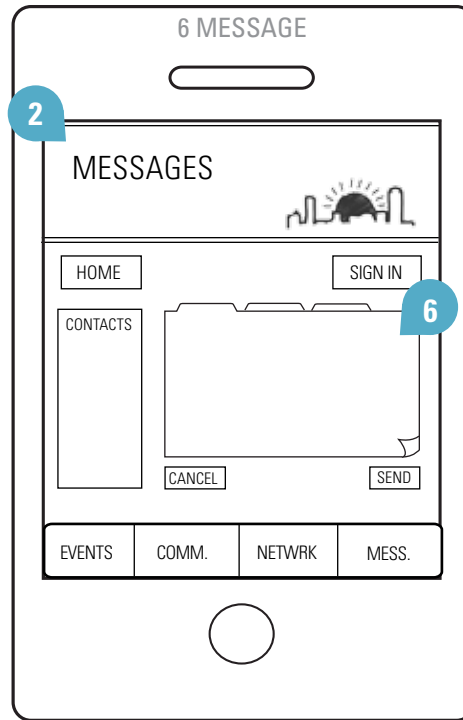
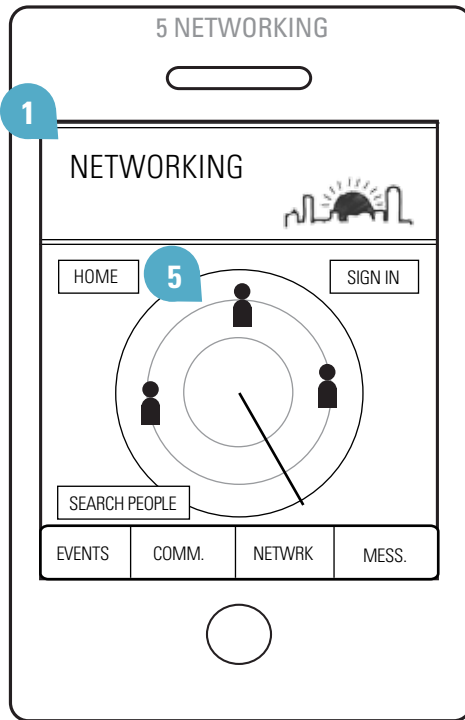

- 1 The networking page will display a radar screen that shows the location of the people in your event community. The user has the option to search for people in this application.
- 2 The message page allows the user to receive and compose message from other community members
- 3 The event description page will display to the user a brief description of the time, and the topic of a specific event as well as the people who are attending. The user will have to options to join the event community, attend an event or share an event with friends.
- 4 The search event page will include a list of the events organized by topic, types of events and location. The user has the option to change the search criteria to search single or multiple topics.
- 5 The radar screen displays to the user the people within their event community
- 6 The message area includes the users message inbox, outbox and a blank page new messages.